

GENERAL NOTES

ALL CONSTRUCTION SHALL BE IN ACCORDANCE WITH THE REQUIREMENTS SET FORTH BY IBC 2015 AND SHALL CONFORM TO ALL OTHER APPLICABLE MUNICIPAL, STATE, AND FEDERAL REGULATIONS INCLUDING THE ILLINOIS ACCESSIBILITY CODE (2018) AND THE AMERICANS WITH DISABILITIES ACT.

A. GENERAL NOTES

- 1. ALL CONTRACTORS ARE REQUIRED TO VISIT THE SITE AND BE KNOWLEDGEABLE REGARDING EXISTING CONDITIONS AND THEIR EFFECT ON THE PROPOSED WORK. CONTRACTORS SHALL VERIFY AND BE RESPONSIBLE FOR ANY CONDITIONS REQUIRING MODIFICATION BEFORE PROCEEDING WITH THE PROJECT.
2. NOTIFY THE OWNER'S REPRESENTATIVE A MINIMUM OF 72 HOURS PRIOR TO THE INTERRUPTION OF ANY UTILITY.
3. PROTECT AND KEEP IN SERVICE ACTIVE UNDERGROUND UTILITIES, PIPES, OR CONDUITS, WHETHER INDICATED ON THE DRAWINGS OR NOT, UNLESS SPECIFICALLY CALLED FOR TO BE REMOVED, RELOCATED, OR DISCONNECTED AND ABANDONED.
4. CONTRACTORS AND SUBCONTRACTORS SHALL COORDINATE THEIR WORK WITH THAT OF OTHER TRADES.
5. NO WORK WILL BE PERMITTED TO BE INSTALLED WITHOUT RECEIPT AND SUBSEQUENT REVIEW OF FULL AND COMPLETE SUBMITTALS BY THE ARCHITECT/ENGINEER.
6. DO NOT SCALE DRAWINGS, DIMENSIONS INDICATED TAKE PRECEDENCE OVER SCALE.
7. VERIFY ALL DIMENSIONS AND ELEVATIONS IN THE FIELD. WHERE DISCREPANCIES ARE FOUND BETWEEN DIMENSIONS OR ELEVATIONS SHOWN AND ACTUAL FIELD CONDITIONS, NOTIFY ARCHITECT/ENGINEER.
8. WHERE CONFLICTS MAY EXIST BETWEEN THE REQUIREMENTS OF PORTIONS OF THE CONTRACT DOCUMENTS, THE GREATER QUANTITY, HIGHER QUALITY OR MORE STRINGENT REQUIREMENT SHALL GOVERN. THEREFORE, BY EXECUTING A CONTRACT FOR CONSTRUCTION, THE CONTRACTOR AGREES THAT, IF IT RAISED NO QUESTIONS REGARDING SUCH CONFLICTS DURING THE BIDDING PROCESS, AND IN THE ABSENCE OF A CLARIFYING ADDENDUM ISSUED DURING THE BIDDING PROCESS, IT HAS VOLUNTARILY TO COMPLY WITH THE MORE EXPENSIVE REQUIREMENT AS PART OF ITS BASE BID AND IS NOT ENTITLED TO ANY ADDITIONAL COMPENSATION TO RESOLVE THE CONFLICT.
9. THE CONTRACT DOCUMENTS REQUIRE THE CONTRACTOR TO FURNISH AND INSTALL COMPLETE PRODUCTS, SYSTEMS AND SERVICES. BY EXECUTING A CONTRACT FOR CONSTRUCTION, THE CONTRACTOR AGREES THAT THE DRAWINGS SET FORTH THE DESIGN INTENT AND, THEREFORE, MAY NOT EXPRESSLY DEPICT EVERY LENGTH, SEGMENT, PIECE, PART, COMPONENT OR UNIT OF A PRODUCT, SYSTEM OR SERVICE. THE CONTRACTOR FURTHER AGREES THAT, AS PART OF ITS BID, IT MUST FURNISH AND INSTALL EVERY LENGTH, SEGMENT, PIECE, PART, COMPONENT OR UNIT OF A PRODUCT, SYSTEM OR SERVICE AND, CONSEQUENTLY, THE CONTRACTOR IS NOT ENTITLED TO ANY ADDITIONAL COMPENSATION FOR ANY LENGTH, SEGMENT, PIECE, PART COMPONENT OR UNIT OF A PRODUCT, SYSTEM OR SERVICE BECAUSE IT IS NOT EXPRESSLY DEPICTED HEREIN.

B: MISCELLANEOUS AND DEMOLITION NOTES

- 1. COORDINATE PENETRATIONS AND/OR SLEEVES REQUIRED IN WALLS, FLOORS, CEILINGS OR ROOFS FOR MECHANICAL AND ELECTRICAL WORK REQUIRED BY ARCHITECTURAL, MECHANICAL, ELECTRICAL, AND PLUMBING DRAWINGS.
2. SEAL WITH UL APPROVED MATERIALS PENETRATIONS OF DUCTWORK, CONDUIT AND PIPES THROUGH FIRE-RATED ASSEMBLIES, TO MAINTAIN THE RATING INTEGRITY OF THOSE ASSEMBLIES. PROVIDE FIRE DAMPERS AS INDICATED ON THE DRAWINGS.
3. SEAL WITH ACOUSTICAL SEALANT PENETRATIONS OF DUCTWORK, CONDUIT AND PIPES THROUGH NON-RATED FLOORS, FULL-HEIGHT WALLS/PARTITIONS, ACOUSTICALLY INSULATED WALLS/PARTITIONS, AND SOUND-RATED WALLS/PARTITIONS, TO MAINTAIN THE ACOUSTICAL INTEGRITY OF THOSE ASSEMBLIES.
4. APPLY APPROPRIATE & COMPATIBLE SEALANT MATERIALS AS REQUIRED TO SEPARATE DISSIMILAR METALS, FILL GAPS IN EXISTING ASSEMBLIES OR WHERE NEW AND EXISTING ASSEMBLIES MEET OR WHERE OTHERWISE REQUIRED BY THE SPECIFICATIONS.
5. BRING ANY UNFORESEEN OR CONFLICTING CONDITIONS TO THE IMMEDIATE ATTENTION OF THE ARCHITECT/ENGINEER BEFORE PROCEEDING WITH THE WORK.
6. REPAIR, PATCH, OR REPLACE FINISH MATERIALS OR VISIBLE ASSEMBLIES THAT ARE SOILED, CUT OR DAMAGED IN ANY FASHION DURING THE COURSE OF THE WORK. PERFORM PATCHING SUCH THAT EDGES BLEND INTO CONTIGUOUS SURFACES SMOOTHLY, MATCHING TEXTURE AND COLOR OF ADJACENT SURFACES.

STANDARD ABBREVIATIONS

Table with 4 columns of abbreviations and their corresponding full names. Includes terms like ANCHOR BOLT, ACROUSTICAL CEILING PANEL, FLOOR DRAIN, etc.

THE MATERIALS, ABBREVIATIONS, AND DRAFTING SYMBOLS LEGEND ARE EACH AN ALL INCLUSIVE MASTER LIST USED BY THIS FIRM. THE INCLUSION OF THESE LEGENDS INTO THESE DOCUMENTS DOES NOT IMPLY THAT ALL THE SYMBOLS OR MATERIALS INCLUDED IN THESE LEGENDS ARE INCORPORATED INTO THIS PROJECT. ABBREVIATIONS MAY APPEAR WITH PERIODS OR OTHER PUNCTUATION SEPARATING CHARACTERS ON THE DRAWINGS; THE MEANING REMAINS THE SAME.

DRAFTING SYMBOLS AND MATERIALS LEGEND

Table of drafting symbols and materials legend. Includes symbols for detail numbers, column numbers, room numbers, door types, window types, and materials like concrete, brick masonry, stone masonry, steel, etc.

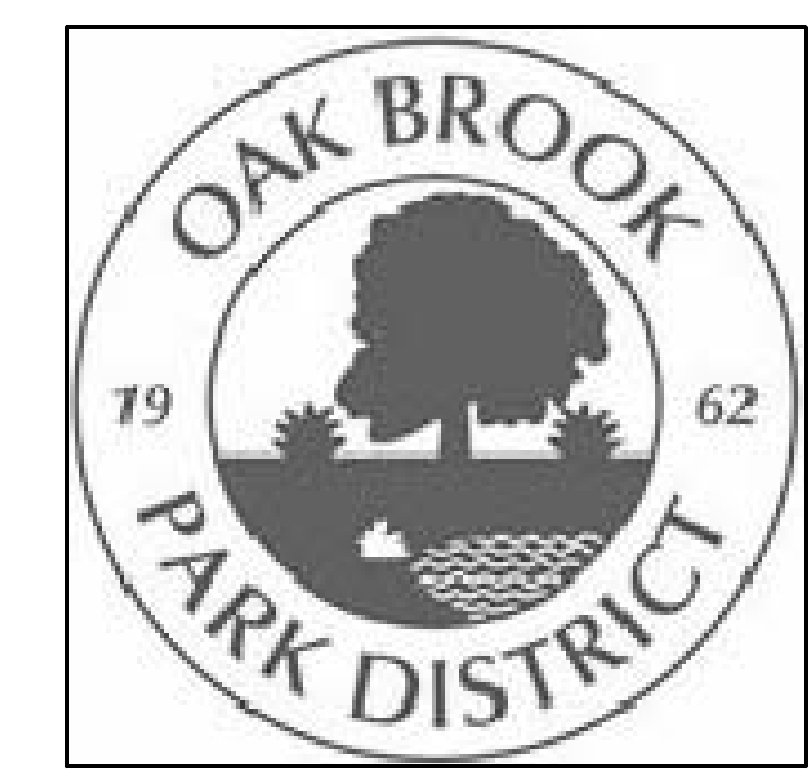

PROJECT

OAK BROOK PARK DISTRICT - FAMILY REC CENTER CEILING REPLACEMENT
1450 FOREST GATE RD
OAK BROOK, IL 60523

OWNER

OAK BROOK PARK DISTRICT
1450 FOREST GATE RD
OAK BROOK, IL 60523

ARCHITECT/ENGINEER

KLUBER ARCHITECTS + ENGINEERS
10 S. SHUMWAY AVE.
BATAVIA, ILLINOIS 60510
TEL (630) 406-1213
FAX (630) 406-9472
www.kluberinc.com

INDEX OF DRAWINGS

Table listing drawing numbers and titles: G100 COVER SHEET, GENERAL NOTES, SYMBOLS, & DRAWING INDEX; A201 REFLECTED CEILING DEMOLITION PLAN; A410 REFLECTED CEILING PLAN.

APPLICABLE CODES

2015 INTERNATIONAL BUILDING CODE
2015 INTERNATIONAL MECHANICAL CODE
2014 ILLINOIS STATE PLUMBING CODE
2014 NATIONAL ELECTRIC CODE
2015 INTERNATIONAL PROPERTY MAINTENANCE CODE
2015 INTERNATIONAL EXISTING BUILDING CODE
2015 INTERNATIONAL FUEL GAS CODE
2015 INTERNATIONAL ENERGY CONSERVATION CODE
ILLINOIS ACCESSIBILITY CODE - CURRENT EDITION
LOCAL AMENDMENTS TO THE ABOVE CODES

SEALS & CERTIFICATIONS

ARCHITECT'S SEAL

MECHANICAL ENGINEER'S SEAL

ELECTRICAL ENGINEER'S SEAL

I HAVE PREPARED, OR CAUSED TO BE PREPARED UNDER MY DIRECT SUPERVISION, THE ATTACHED PLANS AND SPECIFICATIONS AND STATE THAT TO THE BEST OF MY KNOWLEDGE AND BELIEF, AND TO THE EXTENT OF MY CONTRACTUAL OBLIGATION, THEY ARE IN COMPLIANCE WITH IBC 2015 EDITION, THE ENVIRONMENTAL BARRIERS ACT AND THE ILLINOIS ACCESSIBILITY CODE.

KLUBER, INC. ILLINOIS PROFESSIONAL DESIGN FIRM LICENSE #184-001284

"G" SERIES, "A" SERIES

Kluber Architects + Engineers logo and contact information: Batavia, Illinois 60510, Tel: (630) 406-1213, Gurnee, Illinois 60031, Tel: (847) 336-3428, www.kluberinc.com

OAK BROOK PARK DISTRICT - FAMILY REC CENTER CEILING REPLACEMENT
OAK BROOK PARK DISTRICT
1450 FOREST GATE RD
OAK BROOK, IL 60523

Table with columns for document status: ISSUED, REVISION, and DATE.

Table with columns for document tracking: JOB NO., DRAWN, CHECKED, APPROVED, and SHEET TITLE.

COVER SHEET, GENERAL NOTES, SYMBOLS AND DRAWING INDEX

SHEET NUMBER G100

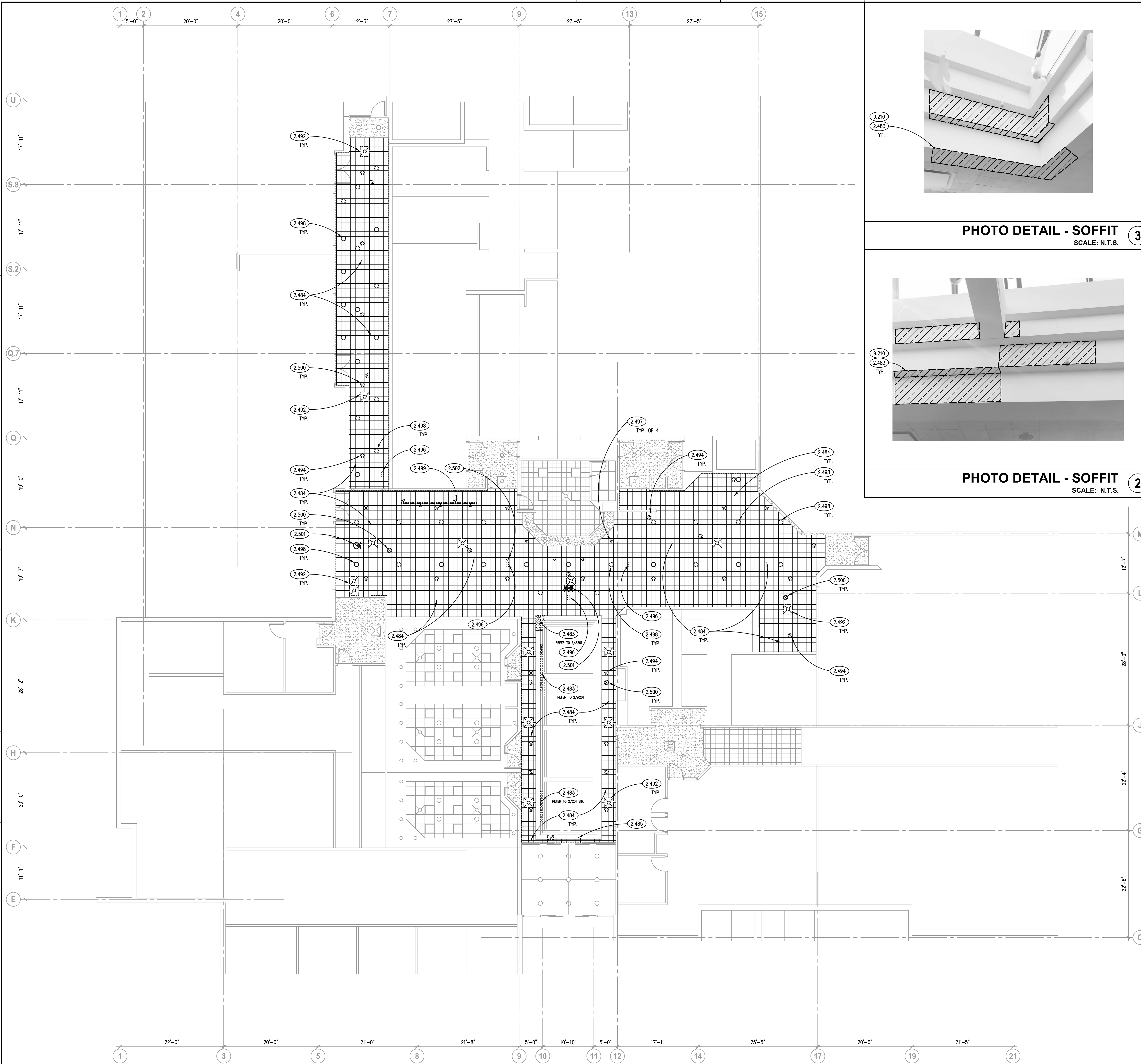

**REFLECTED CEILING DEMOLITION PLAN**  
SCALE: 1/8" = 1'-0" **1**

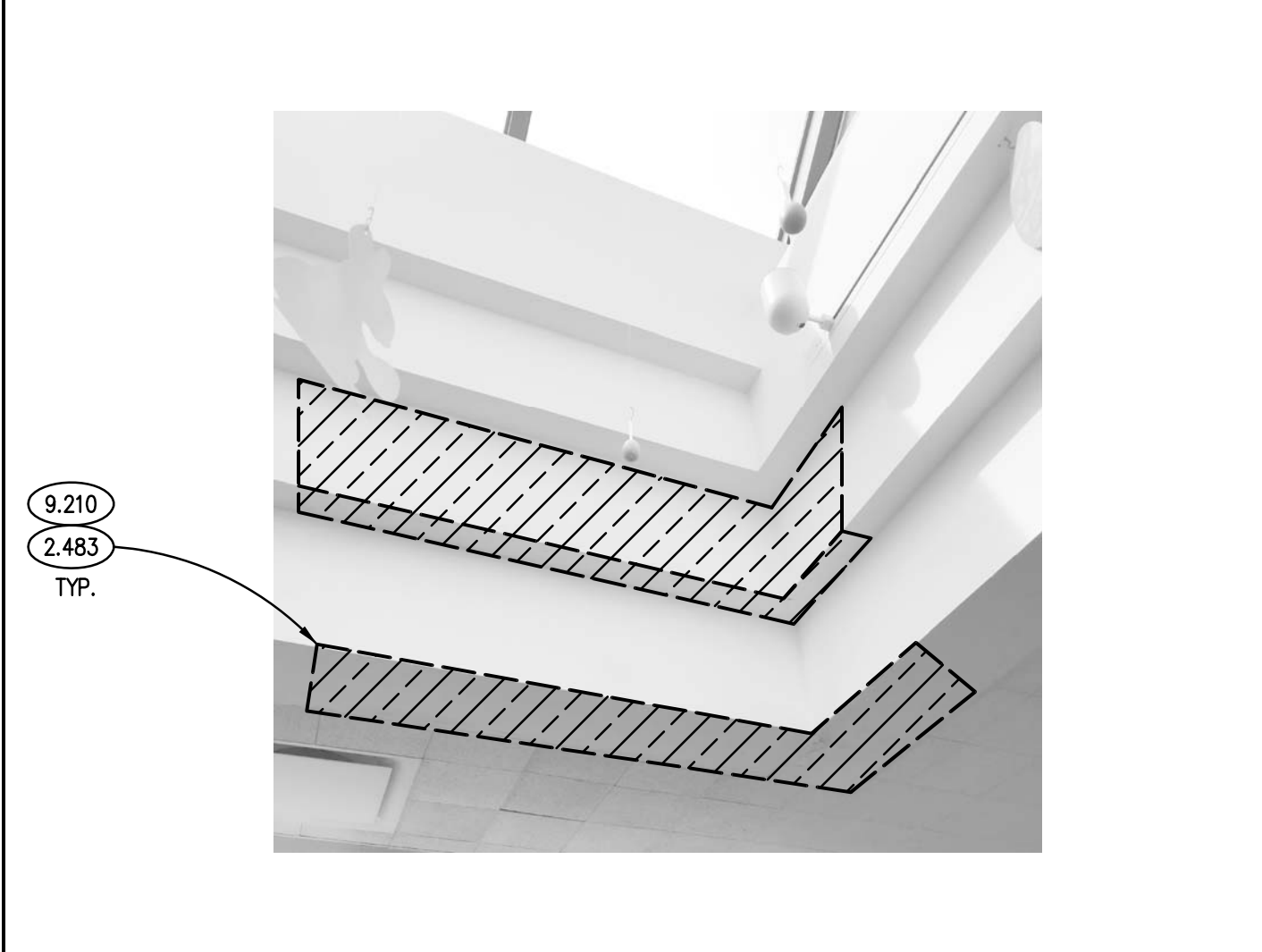

**PHOTO DETAIL - SOFFIT**  
SCALE: N.T.S. **3**

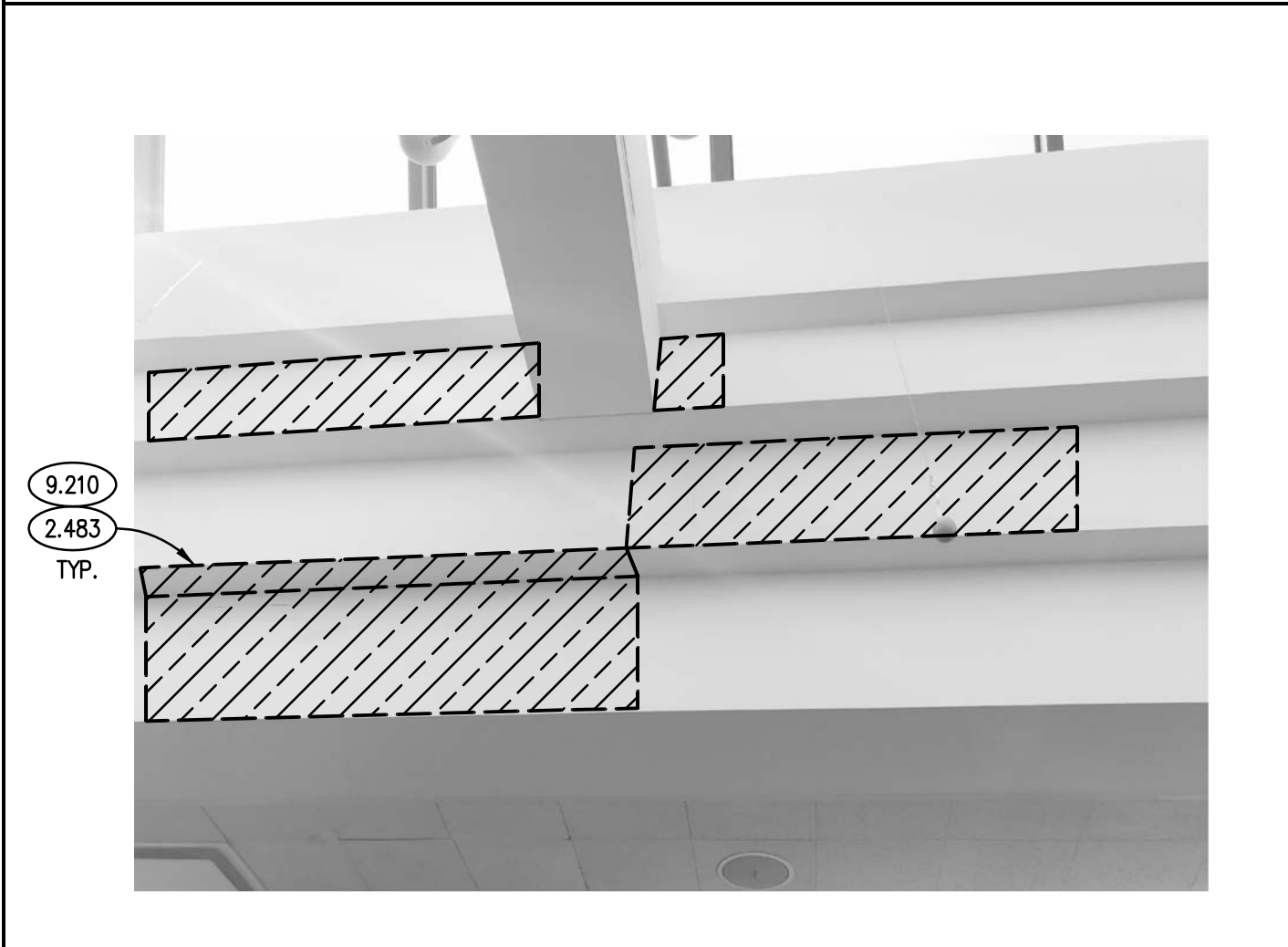

**PHOTO DETAIL - SOFFIT**  
SCALE: N.T.S. **2**

**KEYNOTES**

KEYNOTES ARE TYPICALLY NOT DUPLICATED WITHIN A GIVEN DETAIL. AN UN-KEYNOTED ITEM IN A DETAIL IS THE SAME AS A KEYNOTED ITEM HAVING THE SAME APPEARANCE WITHIN THE SAME DETAIL.

- 2.483 DEMOLISH DAMAGED PORTIONS OF EXISTING GYPSUM BOARD SOFFIT AS INDICATED.
- 2.485 TEMPORARILY SUPPORT EXISTING CABINET UNIT HEATER AND DISCONNECT (2) SUPPORT RODS THROUGH EXISTING CEILING.
- 2.484 DEMOLISH EXISTING INTERIOR CEILING FINISH: TONGUE AND GROOVE PANELS AND SUSPENDED GRID.
- 2.485 DEMOLISH EXISTING INTERIOR CEILING FINISH: ACOUSTICAL PANELS; SALVAGE SUSPENDED GRID IN PLACE.
- 2.492 SALVAGE EXISTING MECHANICAL SYSTEM COMPONENT: CEILING DIFFUSER/GRILLE.
- 2.494 SALVAGE EXISTING FIRE PROTECTION SYSTEM COMPONENT: SPRINKLER HEAD.
- 2.496 DEMOLISH EXISTING SECURITY DEVICE: BOX CAMERA.
- 2.497 SALVAGE EXISTING PENDANT LIGHT FIXTURES. DEMOLISH EXISTING BRANCH CIRCUITRY. RECORD EXISTING CONDITIONS AND CONFIGURATIONS TO MATCH.
- 2.498 SALVAGE EXISTING DOWN LIGHT FIXTURE. (NOTE - ALTERNATE NO. 1 - DEMOLISH EXISTING LIGHT FIXTURE; REFER TO DRAWING 4410 FOR ADDITIONAL INFORMATION.) DEMOLISH EXISTING BRANCH CIRCUITRY. RECORD EXISTING CONDITIONS AND CONFIGURATIONS TO MATCH.
- 2.499 DEMOLISH EXISTING TRACK LIGHTING SYSTEM, INCLUDING BRANCH CIRCUITRY.
- 2.500 SALVAGE EXISTING ELECTRICAL SYSTEM COMPONENT: CEILING SPEAKER. DISCONNECT AND PROTECT EXISTING WIRING TO BE REUSED.
- 2.501 SALVAGE EXISTING ELECTRICAL SYSTEM COMPONENT: EXIT LIGHT FIXTURE. DEMOLISH EXISTING BRANCH CIRCUITRY.
- 2.502 SALVAGE EXISTING SECURITY DEVICE: DOME CAMERA. DISCONNECT AND PROTECT EXISTING WIRING TO BE REUSED.
- 9.210 GYPSUM BOARD: 5/8" THICK; TYPE "X".

**GENERAL NOTES**

1. REFER TO DRAWING G100 FOR PROJECT GENERAL NOTES.
2. STORE SALVAGED ITEMS AS DIRECTED BY OWNER.
3. REMOVE SALVAGED ITEMS THAT WILL NOT BE RE-USED TO OWNER'S DESIGNATED PERMANENT STORAGE LOCATION ON CAMPUS.
4. REMOVE SALVAGED ITEMS THAT WILL ULTIMATELY BE RE-USED ON THIS PROJECT TO OWNER'S DESIGNATED TEMPORARY STAGING AREA ON SITE.
5. PROTECT SALVAGED ITEMS FROM DAMAGE UNTIL INCORPORATED INTO THE WORK OR UNTIL MOVED TO OWNER'S PERMANENT STORAGE.
6. AT CEILING GRID AREAS TO BE DEMOLISHED, TEMPORARILY SUPPORT LIGHT FIXTURES THAT ARE TO INDICATED TO REMAIN IN PLACE AS PART OF THE PERMANENT WORK.

**KEY PLAN**

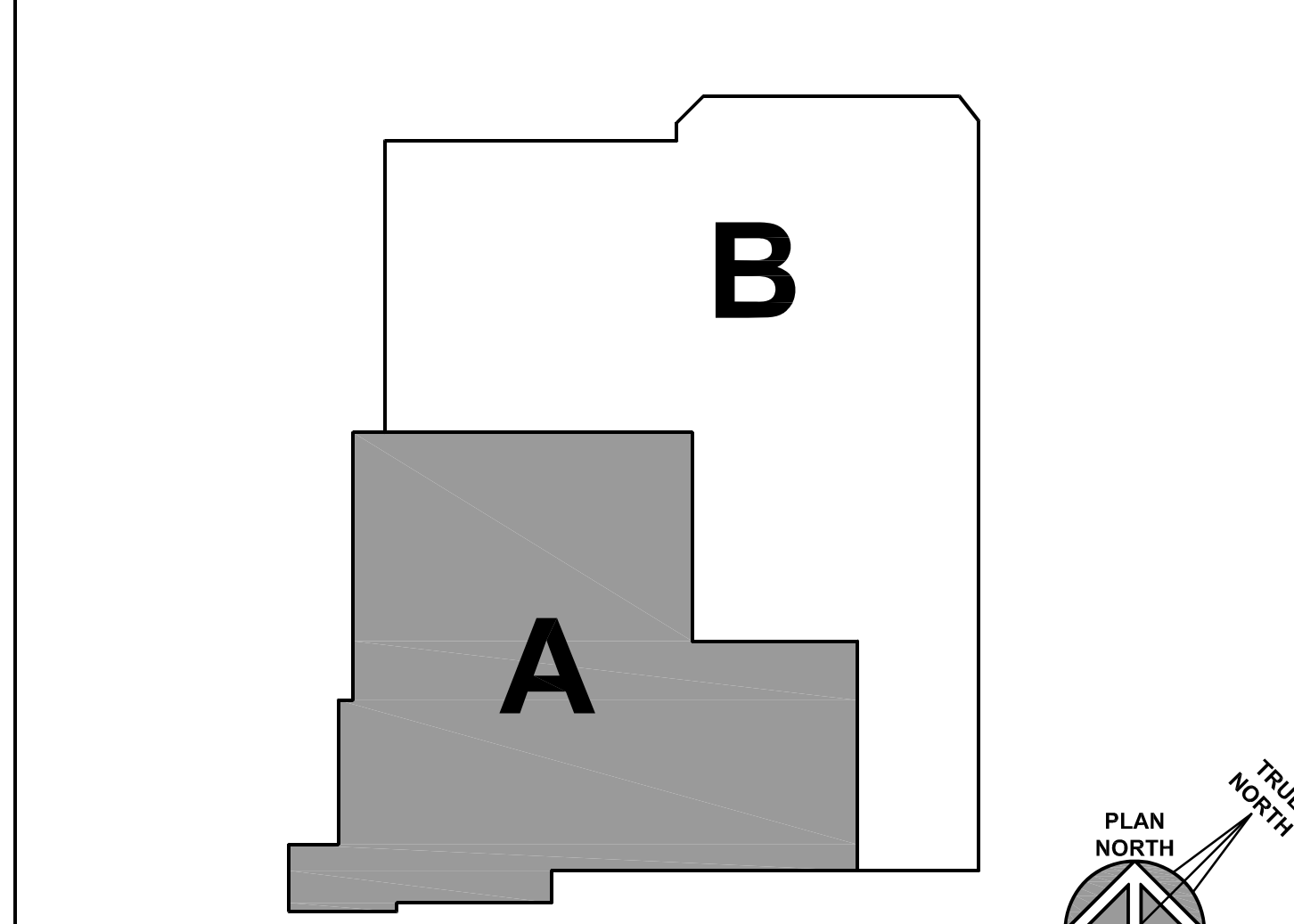

ISSUED	
DATE	
BY	
DESCRIPTION	
JOB NO.	19-310-1252
DRAWN	XXX
CHECKED	XXX
APPROVED	XXX
SHEET TITLE	
REFLECTED CEILING DEMOLITION PLAN	
SHEET NUMBER	
<b>AE201</b>	

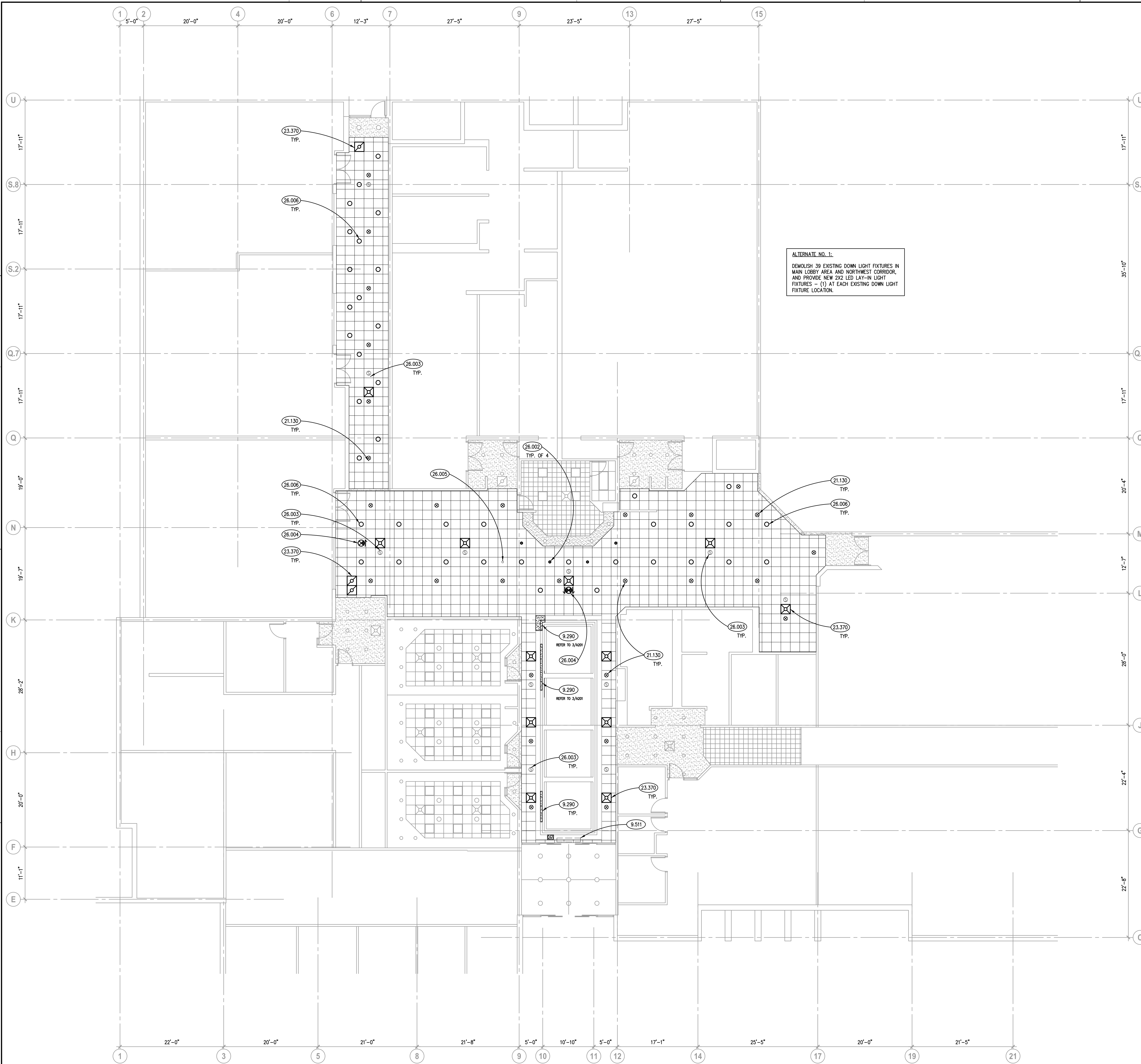

**ALTERNATE NO. 1:**  
 DEMOLISH 39 EXISTING DOWN LIGHT FIXTURES IN MAIN LOBBY AREA AND NORTHWEST CORRIDOR, AND PROVIDE NEW 2X2 LED LAY-IN LIGHT FIXTURES - (1) AT EACH EXISTING DOWN LIGHT FIXTURE LOCATION.

**KEYNOTES**

KEYNOTES ARE TYPICALLY NOT DUPLICATED WITHIN A GIVEN DETAIL. AN UN-KEYNOTED ITEM IN A DETAIL IS THE SAME AS A KEYNOTED ITEM HAVING THE SAME APPEARANCE WITHIN THE SAME DETAIL.

- 9.290 GYPSUM BOARD ASSEMBLY: PATCH HORIZONTAL & VERTICAL SURFACES OF EXISTING GYPSUM BOARD SOFFIT AS INDICATED; PROVIDE NEW GYPSUM BOARD IN THICKNESS MATCHING THAT OF EXISTING; FEATHER FINISHED EDGES OF PATCH TO CREATE A SMOOTH TRANSITION TO THE EXISTING SURFACE.
- 9.511 ACOUSTICAL CEILING ASSEMBLY: THREAD (2) EXISTING SUPPORT RODS FOR CABINET UNIT HEATER THROUGH NEW CEILING TILES W/O CUTTING OR BREAKING TILES; RECONNECT SUPPORT RODS TO EXISTING STRUCTURE.
- 21.130 PROVIDE ALL MATERIAL AND LABOR TO RELOCATE SPRINKLER HEADS TO CENTER OF 2'X 2' GRID AS INDICATED.
- 23.370 REINSTALL SALVAGED MECHANICAL DIFFUSER/GRILLE.
- 26.002 REINSTALL SALVAGED PENDANT LIGHT FIXTURES. PROVIDE NEW BRANCH CIRCUITRY TO LUMINAIRES FROM EXISTING PANELBOARD AS REQUIRED TO ENSURE A COMPLETE AND OPERATIONAL SYSTEM. MATCH EXISTING INCLUDING ALL LIGHTING CONTROL.
- 26.003 REINSTALL SALVAGED ELECTRICAL SYSTEM COMPONENT: CEILING SPEAKER. EXTEND EXISTING WIRING AS NECESSARY TO ENSURE A COMPLETE AND OPERATIONAL SYSTEM.
- 26.004 REINSTALL SALVAGED ELECTRICAL SYSTEM COMPONENT: EXIT LIGHT FIXTURE. INTERCEPT AND EXTEND EXISTING EXIT LIGHT BRANCH CIRCUIT FROM NEAREST LOCATION.
- 26.005 REINSTALL SALVAGED SECURITY DEVICE: DOME CAMERA. EXTEND EXISTING WIRING AS NECESSARY TO ENSURE A COMPLETE AND OPERATIONAL SYSTEM.
- 26.006 REINSTALL SALVAGED DOWN LIGHT FIXTURE; PROVIDE NEW MOUNTING BRACKET AND TRIM RING AS MAY BE REQUIRED FOR REINSTALLATION. PROVIDE NEW BRANCH CIRCUITRY TO LUMINAIRES FROM EXISTING PANELBOARD AS REQUIRED TO ENSURE A COMPLETE AND OPERATIONAL SYSTEM. MATCH EXISTING INCLUDING ALL LIGHTING CONTROL.

**CEILING SYMBOL LEGEND**

SYMBOL	DESCRIPTION	SYMBOL	DESCRIPTION
	GYPSUM BOARD		MECHANICAL DIFFUSER: SUPPLY
	ACOUSTICAL CEILING TILE: 2' X 2'		MECHANICAL DIFFUSER: RETURN
			LIGHT FIXTURES: 2' X 2'
			DOWN LIGHT FIXTURES: A: SPOT B: PENDANT C: WALL WASHER D: SCORCE
			EXIT LIGHT FIXTURES
			EMERGENCY LIGHT FIXTURES
			SPRINKLER HEADS: A: PENDANT B: UPRIGHT C: CONCEALED D: SIDEWALL
			CEILING SPEAKERS
			DOME CAMERA

**GENERAL NOTES**

1. REFER TO DRAWING G100 FOR PROJECT GENERAL NOTES.
2. PROVIDE GYPSUM BOARD HEADERS TO FORM VERTICAL SOFFITS AT CHANGES OF ACOUSTICAL CEILING HEIGHTS UNLESS NOTED OR DETAILED OTHERWISE.
3. ALL CEILING HEIGHTS WILL MATCH EXISTING HEIGHTS UNLESS OTHERWISE NOTED.

**KEY PLAN**

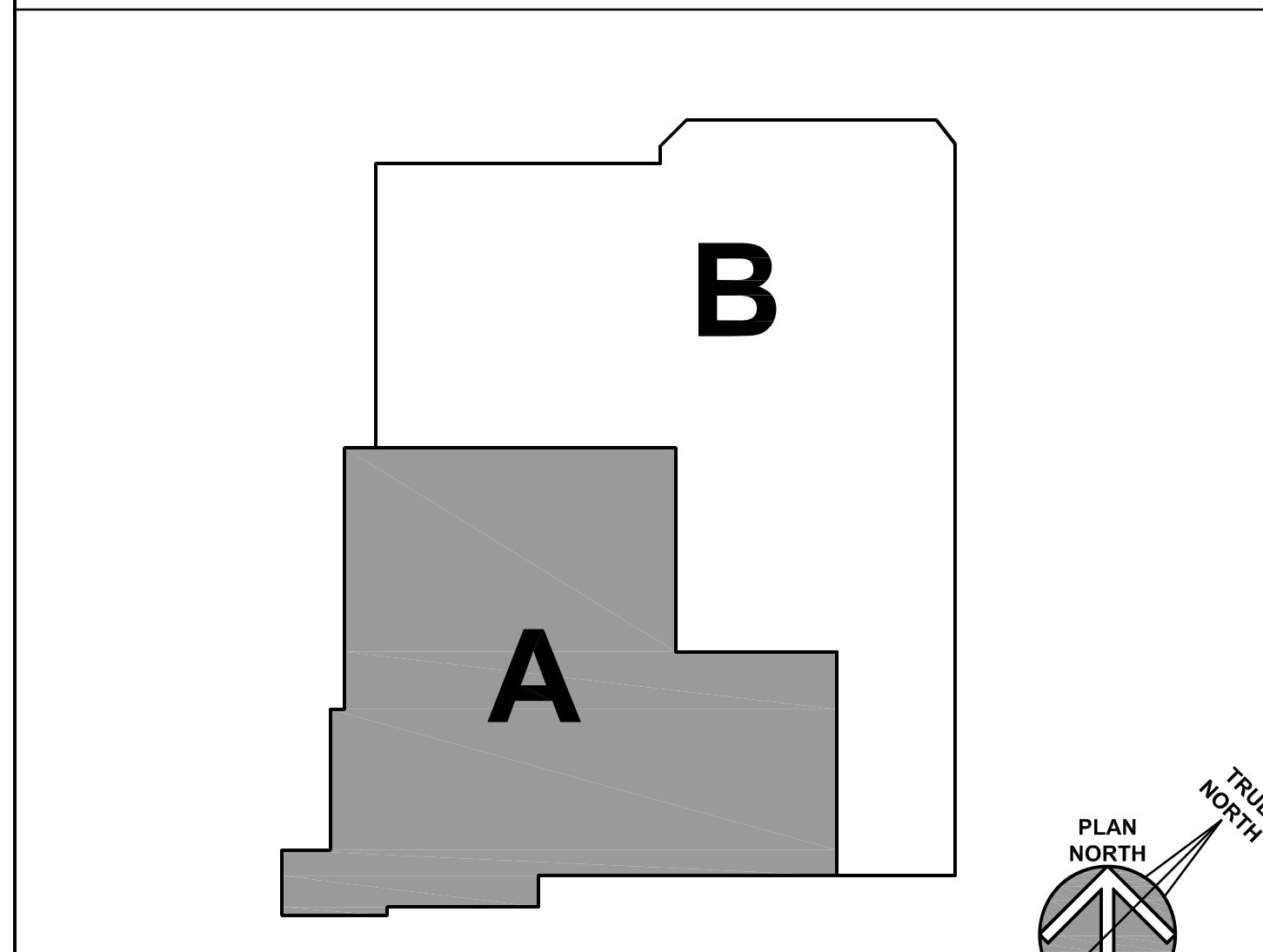

**REFLECTED CEILING PLAN**  
 SCALE: 1/8" = 1'-0"

**Kluber**  
 Architects + Engineers

Kluber, Inc.  
 Batavia, Illinois 60510  
 Tel. 630.406.2170  
 Gurnee, Illinois 60031  
 Tel. 847.336.4288  
 www.klubertec.com

**OAK BROOK PARK DISTRICT - FAMILY REC CENTER CEILING REPLACEMENT**

OAK BROOK PARK DISTRICT  
 1450 FOREST GATE RD  
 OAK BROOK, IL 60523

ISSUED	
QUANTITY	
BID DOCUMENTS	
JOB NO.	19-310-1252
DRAWN	PJT/ATR
CHECKED	XXX
APPROVED	XXX
SHEET TITLE	
REFLECTED CEILING PLAN	
SHEET NUMBER	
<b>AE410</b>	